

BI2-S12 Proximity Switch

Operation Manual



99 Washington Street
Melrose, MA 02176
Phone 781-665-1400
Toll Free 1-800-517-8431

Visit us at www.TestEquipmentDepot.com

Model BI2-S12 is a three-wire proximity switch designed to detect metal when placed in front of a sensing surface. The BI2-S12 includes an LED to indicate if an object in front of the sensor is present. This sensor is short circuit, overload, and reversed polarity protected to protect your sensor from damage.

Features include a pre-wired 2 m cable assembly for easy installation. This sensor is suitable for direct use with Shimpo panel meters, stroboscopes or competitor's products. It can be used with a single projection head or can be used with multiple projection heads.

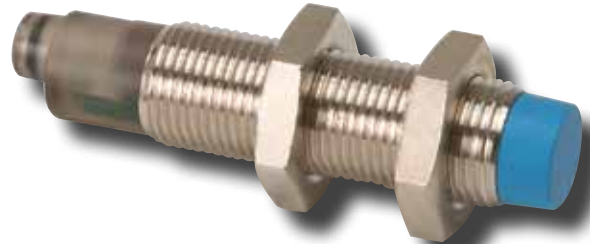

CONNECTIONS

Lead	Tachometer Terminal
Brown	10-30 VDC (positive)
Blue	0V (GND)
Black	Signal

* Use 4.7 k Ohm pull-up resistors if an open collector input is not available.

DIMENSIONS

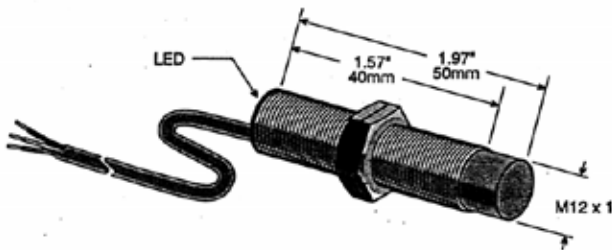

SPECIFICATONS

Sensing Distance: 0.08" (2 mm) sensing distance.

Switching Frequency: 1.5 KHz

Output: PNP, NPN

Housing Material: Nickel-plated brass

Sensing Head Material: Crastin

Ambient Temperature: -25 to 70°C (-13 to 158°F)

Supply Voltage: 10 - 30 VDC

Protection ITC: IP67

Electromagnetic Compatability Compliance: NEMA ICS5-2000

Cable: 2-meter (6.56'), PVC covered, 3-conductor, #26AWG

NIDEC-SHIMPO CORPORATION

INSTRUMENTS DIVISION • Test Equipment Depot - 800.517.8431 - 99 Washington Street Melrose, MA 02176

TestEquipmentDepot.com