

THIS IS ISSUED IN STRICT CONFIDENCE THAT IT IS NOT USED AS A BASIS FOR MANUFACTURE OR SALE AND THAT IT IS NOT COPIED, REPRINTED OR DISCLOSED TO A THIRD PARTY EITHER WHOLLY OR IN PART WITHOUT THE PRIOR WRITTEN CONSENT OF CAL TEST ELECTRONICS, INC.

Test Equipment Depot

99 Washington St. Melrose MA, 02176
1.800.517.8431 | 781.665.0780 (Fax)

© Visit us at www.TestEquipmentDepot.com

1. SAFETY SOCKET w/ $\varnothing .080(\varnothing 2.0)$ SOLDER HOLE.
2. SPECIFICATIONS:
INSULATOR: POLYAMIDE
CONTACT: BRASS, NICKEL PLATED
LOCKING NUT: BRASS, NICKEL PLATED
3. RATING:
VOLTAGE: 1,000V CATIII P2 (IEC61010-1)
CURRENT: 25A MAX.
RESISTANCE: $<5m\Omega$.
TEMPERATURE: $-20^{\circ}C$ TO $+80^{\circ}C$.
4. MOUNTING HOLE: REF. DIAGRAM
5. INSULATOR THREAD, M12 X 0.75
6. MAXIMUM PANEL THICKNESS: .40 (10.2).

PART NUMBER

CT2240-#

COLOR: 0 - BLACK
1 - BROWN
2 - RED
3 - ORANGE
4 - YELLOW
5 - GREEN
6 - BLUE
7 - PURPLE
8 - GRAY
9 - WHITE

CONFORMITY TO RoHS 2002/95/EC

REVISIONS

REV.	DESCRIPTIONS	DATE	APPROVED
—	CLASS A RELEASED	7/12/99	
A	REVISED CONFIGURATION & MATL. MOUNTING HOLE. NEW TOOLING.	4/18/04	

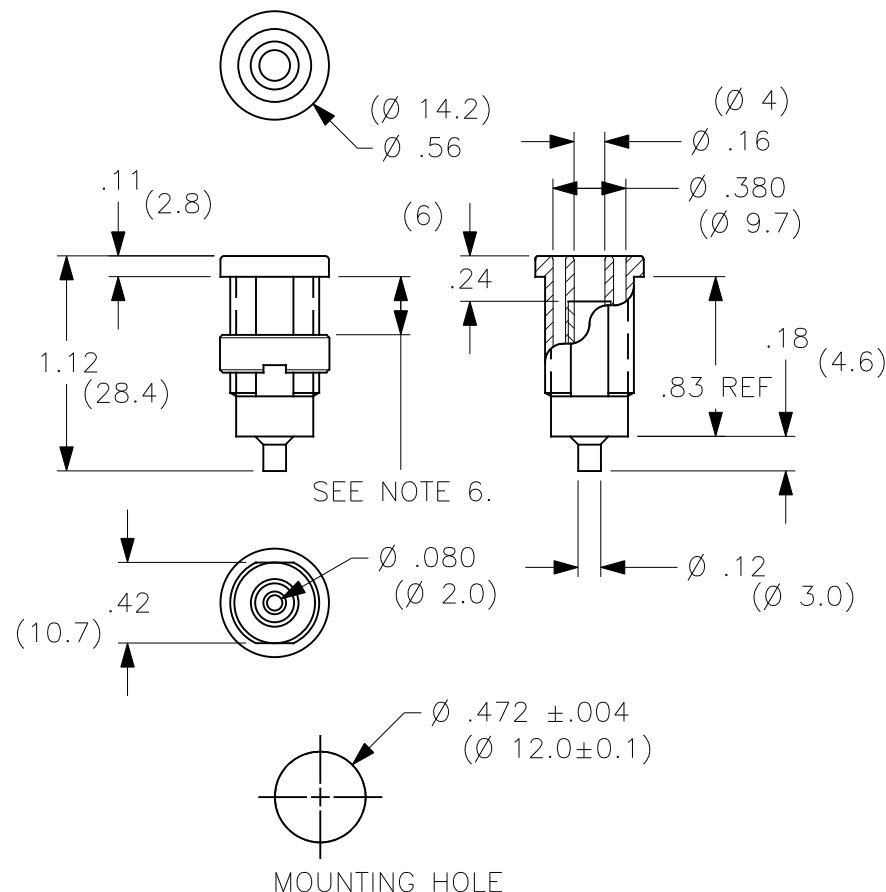

THIRD ANGLE PROJECTION

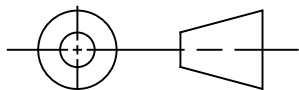

UNLESS OTHERWISE SPECIFIED
DIMENSIONS ARE IN INCHES
TOLERANCES ARE:
FRACTIONS DECIMALS
 $\pm 1/32$.XX $\pm .02$
DO NOT SCALE DRAWING .XXX $\pm .005$

CONTRACT NO.

APPROVALS

DATE

DRAWN WDH

7/12/99

CHECKED

ENGR.

DESIGN ACTIVITY

Cal Test Electronics

22820 Savi Ranch Parkway
Yorba Linda, CA

TITLE

4mm SAFETY SOCKET,
w/ $\varnothing .080(\varnothing 2mm)$ SOLDER HOLE

SIZE
A

CAGE CODE
43F45

DWG. NO.

P224000

REV.
A

SCALE 1:1

SHEET 1 OF 1