

THIS IS ISSUED IN STRICT CONFIDENCE THAT IT IS NOT USED AS A BASIS FOR MANUFACTURE OR SALE AND THAT IT IS NOT COPIED, REPRINTED OR DISCLOSED TO A THIRD PARTY EITHER WHOLLY OR IN PART WITHOUT THE PRIOR WRITTEN CONSENT OF CAL TEST ELECTRONICS, INC.

Test Equipment Depot
 99 Washington St. Melrose MA, 02176
 1.800.517.8431 | 781.665.0780 (Fax)

Visit us at www.TestEquipmentDepot.com

- 4mm SAFETY BANANA JACK w/M3 THREADED HOLE.
- SPECIFICATIONS:
 INSULATOR: POLYAMIDE (NYLON).
 CONTACT: BRASS, NICKEL PLATED
 LOCKING NUT: BRASS, NICKEL PLATED
- RATING:
 VOLTAGE: 1,000 V CAT III/600 V CAT IV P2 (IEC61010-031)

 CURRENT: 36 A MAX.
 RESISTANCE: <12 mΩ.
 TEMPERATURE: -20° C TO +80° C.
- MOUNTING HOLE: REF. DIAGRAM.
- INSULATOR THREAD, M12x0.75, MAX. TORQUE 1.7 ft-lb (2.3 Nm) AT 20° C.
- MAXIMUM PANEL THICKNESS: .40 (10).
- RECOMMENDED ASSEMBLY TOOL: CT2246A.

REVISIONS			
REV.	DESCRIPTIONS	DATE	APPROVED
-	CLASS A RELEASED	7/12/99	
A	ADDED CAGE CODE	6/10/05	
B	COLOR ORANGE ADDED AS SPECIAL; REVISED NOTE 5 WITH NUT TORQUE SPECIFICATION.	6/2/09	

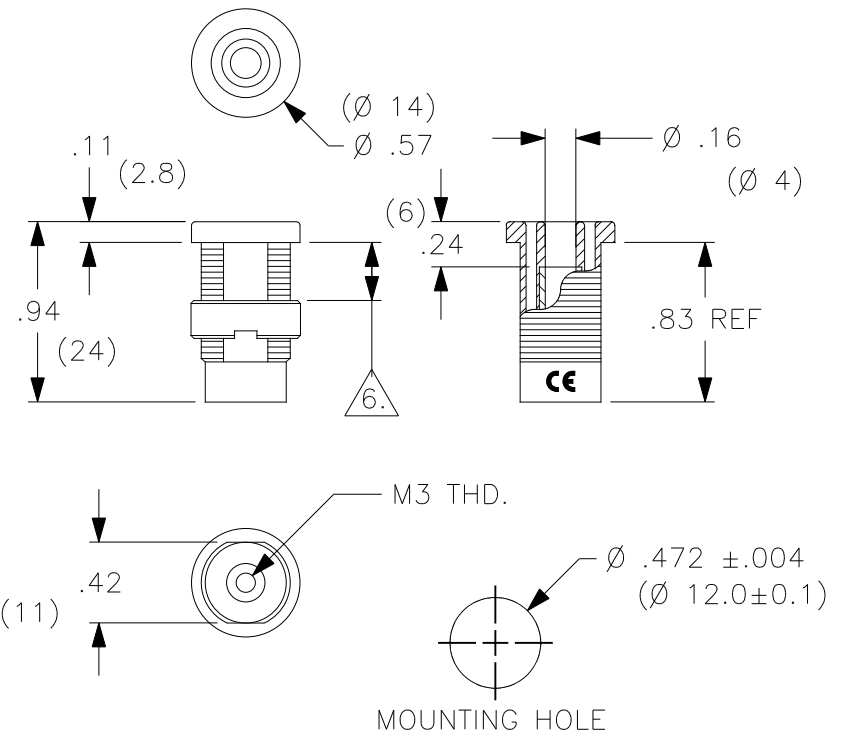

PART NUMBER

CT2908-#

- COLOR:
- 0 - BLACK
 - 1 - BROWN
 - 2 - RED
 - 3 - ORANGE (SPECIAL)
 - 4 - YELLOW
 - 5 - GREEN
 - 6 - BLUE
 - 7 - PURPLE
 - 8 - GRAY
 - 9 - WHITE

CONFORMITY TO RoHS 2002/95/EC

THIRD ANGLE PROJECTION		UNLESS OTHERWISE SPECIFIED DIMENSIONS ARE IN INCHES TOLERANCES ARE: FRACTIONS DECIMALS $\pm 1/32$.XX $\pm .02$.XXX $\pm .005$ DO NOT SCALE DRAWING		CONTRACT NO.		Cal Test Electronics 22820 Savi Ranch Parkway Yorba Linda, CA					
		MATERIAL		APPROVALS		DATE		TITLE			
		FINISH		DRAWN WDH		7/12/99		4mm SAFETY JACK, PANEL w/M3 THREADED HOLE			
NEXT ASSY		USED ON		ENGR.		DESIGN ACTIVITY		SIZE A	CAGE CODE 43F45	DWG. NO. P290800	REV. B
APPLICATION								SCALE 1:1	SHEET 1 OF 1		