



EasyLog



EL-USB

**Test Equipment
Depot**

1-800-517-8431

Quick Start Guide

DOWNLOAD AND INSTALL SOFTWARE

Windows™ 7/8/10 (32 & 64bit)

Visit www.lascarelectronics.com/software and click 'Download'.

The screenshot shows the LASCAR electronics website interface. At the top right, there are contact details: 'Login - Create Account', 'sales@lascar.co.uk', and '+44(0)1794 884147'. Below this is a search bar and a navigation menu with links for 'Home', 'Products', 'PowerPack2 University', 'EasyLog Cloud', 'Software', 'Markets', 'About Us', 'Structure', 'News', 'Events', 'Support', and 'Case Studies'. The main content area is titled 'EasyLog USB'. It features the EasyLog logo, a 'DOWNLOAD' button, and text stating: 'Download version 1.2 of our **EasyLog** USB software, compatible with 32-bit and 64-bit versions of Windows 7, 8 and 10. The speed buffer of the software includes support for the **EL-USB-1** smart and stable data logger as well as improvements to the graphing interface. If you are unsure if this is the software you need to download, check our 'Software for use with' page and table link below as well.' Below this is a 'Welcome to EasyLog USB Software' section with a large blue image placeholder. On the left side, there is a 'Software for use with' list containing: EasyLog USB, PowerPack2, PowerPack2 Data logger, PowerPack4, PowerPack4, EasyLog H1, EasyLog H10, EasyLog T200, EasyLog T200 Cloud, EasyLog S40, EasyLog BT for Android, EasyLog BT for iPad, and EasyLog BT. A 'Chat Now' button is visible at the bottom left.

USING THE SOFTWARE

- Insert the data logger into an available USB port on your PC.
- Double click on the EasyLog USB icon on your Windows™ desktop. This will load the configuration software. Click 'Set up and start the USB data logger' and follow the set-up wizard.



- When setup is complete, the data logger should be removed from the USB port. **Do not leave your data logger in the USB port for extended periods as this will cause some of the battery capacity to be lost** (with the exception of EL-USB-1-RCG).
- You can also download the data from a logger that has been recording or view previously saved data from the software.

REPLACING YOUR DATA LOGGER'S BATTERY

Your data logger is provided with a 3.6V 1/2AA battery already installed. You can change the battery by following the instructions below.

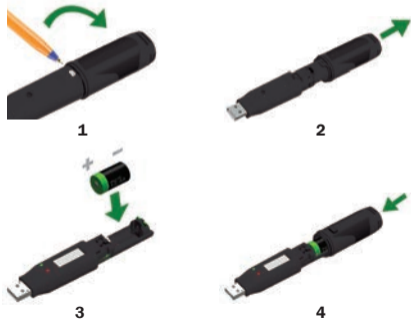

EL-USB-1 PRO

Before using the data logger you will need to insert the 3.6V 2/3AA High Temperature battery provided, following the instructions below.

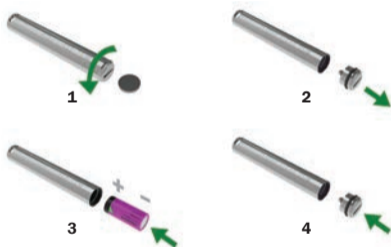

EL-USB-1-RCG

The EL-USB-1-RCG's battery is preinstalled. To charge the battery, connect to a USB port until the green LED shows. The rechargeable battery should only be replaced by an authorized supplier.

OUR RANGE

EL-USB

Simple Low Cost
Data Logging



- USB interface for configuration and download
- Easy to use Windows control software

EL-CC

Cold Chain Logistics
Loggers



- Low cost, reusable and waterproof
- Comes with pre-configured alarms

EL-GFX

Advanced Data Logging



- Graphic LCD for real-time readings and graph
- Compact and robust design

EL-WiFi

Wireless Data Logging



- Cloud based monitoring with email alerts
- Connects to an existing WiFi network

EL-MOTE

Cloud-based Data
Logging



- Cloud based monitoring from any internet enabled device
- Quick and easy set-up from smartphone App

Temperature



**Temperature/
Relative Humidity**



Voltage



Current



Event, State & Count



Thermocouple



Carbon Monoxide



Thermistor



IMPORTANT SAFETY INFORMATION



Repairing or Modifying

Never attempt to repair or modify Lascar products. Dismantling them, other than for the purpose of changing replaceable batteries, may cause damage that is not covered under the warranty. Servicing should only be provided by an authorized supplier.



Disposal and Recycling Information

You must dispose of Lascar products in accordance with relevant laws and regulations. They contain electronic components and lithium batteries and therefore must be disposed of separately from household waste.



5 Commonwealth Ave
Woburn, MA 01801
Phone 781-665-1400
Toll Free 1-800-517-8431



Visit us at www.TestEquipmentDepot.com