



# VERSO ARM USER GUIDE ADDENDUM

## UNPACKING

- 1 VERSO Arm
- 2 VERSO Base Mount
- 3 VERSO Bench Clamp
- 4 Clamp Fixing Screws (4)
- 5 Dust Cover
- 6 Movement restrictor handle, washer and pivot washers
- 7 Tools
- 8 Mounting point covers (PIXO/ERGO & IOTA)
- 9 VERSO Forearm Pack (Option)



### VERSO Forearm Pack (Option)

- A VERSO Forearm
- B Extension Power Cable
- C Pivot washer
- D Movement restrictor handle and washer

# ASSEMBLY

## STEP ONE: SETUP THE VERSO ARM

The VERSO arm can be mounted to a work-surface using either the Bench Clamp or by screwing directly onto a surface of sufficient strength.

If using the Bench Clamp, connect this to the Base Mount using the 4 fixings provided.

If mounting directly onto the work surface, use 4x M5 bolts and nuts (not provided) through the outer 4 holes of the Base Mount.

When Base Mount is secured to the work surface carefully lower the Verso arm onto the Base Mount until they are flush with no gap between them.

When located properly the VERSO arm should rotate easily.



VERSO base mount mounting options

**B** Bench Clamp

**D** Direct Mount

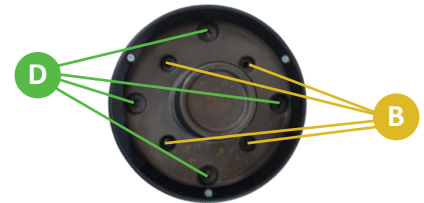

### FOREARM SETUP (OPTIONAL)

Place the washer on the pin then lower the Forearm onto the mounting pin on the end of the VERSO Arm.

Secure the Forearm with the washer and movement restrictor provided.

## STEP TWO: MOUNT THE MANTIS HEAD TO THE VERSO ARM



1. Remove mounting point covers on the head by gently lifting the top cover with a flat head screwdriver and gently squeezing the sides of the bottom cover to slide out. Included with the VERSO arm is a new black cover for your model which should be fitted after the head is mounted to the VERSO arm.



2. Place the pivot washer on the mounting pin and lower the head onto the mounting pin and make sure the head is mounted straight, and the pin is all the way through the mounting hole.



3. Secure the head to the stand with the retaining washer and lever provided using the included tools.

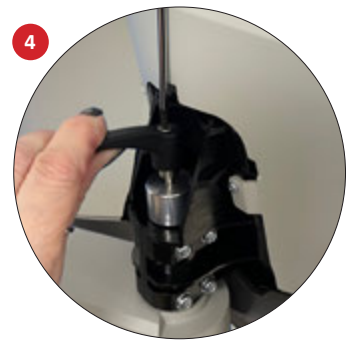

4. Hold the handle firmly with one hand and at the same time use the tool to press the screw head down turning clockwise into the mounting hole to disengage the lever.

Once the lever is in place return the mounting point covers.

# ADJUSTMENTS



## VERTICAL MOVEMENT RESTRICTOR

Use the vertical movement restrictor handle on the right hand side of the VERSO Arm to apply friction and/or lock the vertical movement of the arm in place.

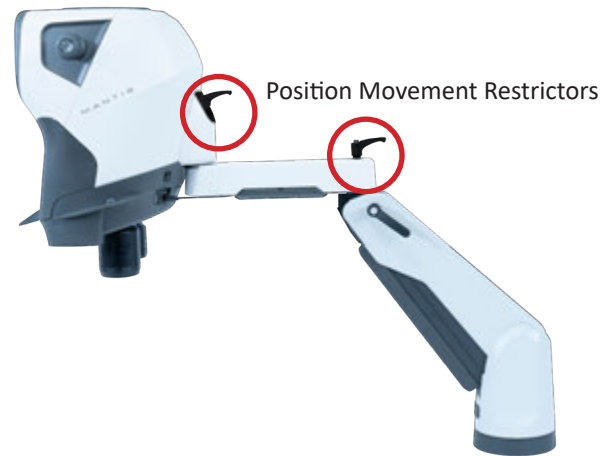

## POSITION MOVEMENT RESTRICTOR

Use the movement restrictor handles on the head and extension arm to apply friction to restrict the movement of the pivot points.

## VERSO ARM COUNTERBALANCE

The VERSO arm counterbalance should be adjusted depending on the weight of the head mounted on it.

The weight varies between PIXO, ERGO, IOTA with objectives fitted and if the Forearm is used.

### TO ADJUST THE COUNTERBALANCE

Remove the Cable Tidy Cover to expose the Thumbwheel adjuster.

1. Rotate the thumbwheel to the left (towards +) to increase the counterbalance for heavier loads (PIXO/ERGO).
2. Rotate the thumbwheel to the right (towards -) to decrease the counterbalance for lighter loads (IOTA).

Adjust the control until the arm balances unaided when placed in the middle of its travel.



Always make sure that the system is fully supported when adjusting the counterbalance.



! Mounting point covers for each Mantis model



PIXO/ERGO



IOTA

! Pivot washers for each Mantis model



PIXO/ERGO



IOTA

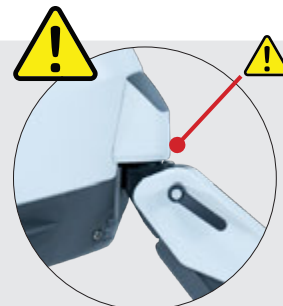

Warning! Always adjust head position with the "wings" on the head. Be aware of potential finger traps from moving joints of the VERSO arm.

# VERSO ARM USER GUIDE

## WARRANTY

This product is warranted to be free from defects in material and workmanship for a period of two years from the date of invoice to the original purchaser.

If during the warranty period the product is found to be defective, it will be repaired or replaced at facilities of Vision Engineering or elsewhere, all at the option of Vision Engineering. However, Vision Engineering reserves the right to refund the purchase price if it is unable to provide replacement, and repair is not commercially practicable or cannot be timely made. Parts not of Vision Engineering manufacture carry only the warranty of their manufacturer. Expendable components such as fuses carry no warranty.

This warranty does not cover damage in transit, damage caused by misuse, neglect, or carelessness, or damage resulting from either improper servicing or modification by other than Vision Engineering approved service personnel. Further, this warranty does not cover any routine maintenance work on the product described in the user guide or any minor maintenance work which is reasonably expected to be performed by the purchaser.

No responsibility is assumed for unsatisfactory operating performance due to environmental conditions such as humidity, dust, corrosive chemicals, deposition of oil or other foreign matter, spillage, or other conditions beyond the control of Vision Engineering.

Except as stated herein, Vision Engineering makes no other warranties, express or implied by law, whether for resale, fitness for a particular purpose or otherwise. Further, Vision Engineering shall not under any circumstances be liable for incidental, consequential or other damages.

Vision Engineering Ltd. has been designing and manufacturing high quality ergonomic microscopes, digital instruments, inspection and non-contact measuring systems for over 60 years.

Vision Engineering has a network of offices and technical distributors around the world. For more information, please contact your Vision Engineering branch, local authorised distributor, or visit our website.



FM 557119

Vision Engineering Ltd.  
has been certified for the  
quality management  
system ISO 9001:2015

