



Wireless Alert PRO



Quick Start Guide

- 1 Download the FilesThruTheAir app and create a user account.



Create an Account



- 2 Connect to power via the USB cable provided and a USB power adapter (optional accessory PSU-5VDC-USB-INTL-WHT)



- 3 Configure and connect your Wireless Alert PRO

Login to the FilesThruTheAir app, select the + icon and follow the step-by-step instructions to set alarm levels, notification preferences, and connect to a Wi-Fi network.

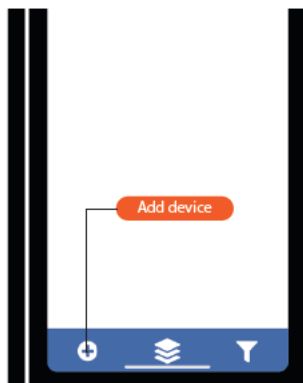
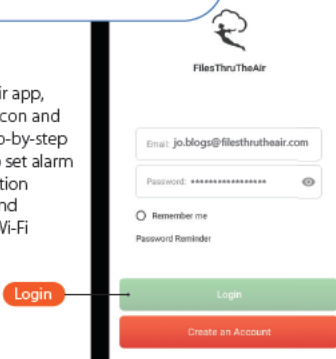

Product Overview

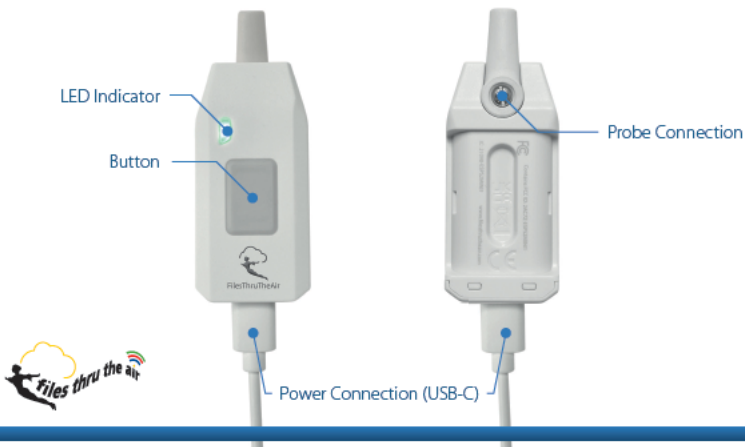

| LED Indication | Meaning |
|---|--|
| Green Flash Red Flash Green Flash (on Button Press) | Device is in Factory Default Mode |
| Green Flash Every Ten Seconds (or on Button Press) 10s | Device is Operating and Within Alert Limits |
| Red Flash Every Ten Seconds (or on Button Press) 10s | Device is Operating and in Alert |
| Amber Flash Every Ten Seconds (or on Button Press) 10s | Device has Identified a Fault/Warning or Loss of Connection |
| Blue Flash | Device is Communicating with Server |
| Green Flash Every Four Seconds 4s | Device is in Setup Mode |
| Long Green Flash | Setup was Successful |
| Long Red Flash | Setup Failed |
| Red Flash Green Flash Red Flash | Factory Reset Complete (after Ten-Second Button Hold) |
| Button Press | Function |
| Quick Press | Status Check (Refer to LED Indicator Table for Status Reference) |
| Three-Second Hold | Enter Setup Mode |
| Ten-Second Hold | Factory Reset |

Installation

1
Install the bracket using the two screws provided



2
Clip the Wireless Alert into the bracket



3
Connect the Wireless Alert to a power supply



Safety Information

Refer to the FilesThruTheAir app for safety and legal information. Corintech Ltd. declares that this wireless device is in compliance with Directive 2014/53/EU. The complete EU Declaration of Conformity is available at www.files thru the air.com/support

Repairing or Modifying

Never attempt to repair or modify Corintech Ltd products. Dismantling them, other than for the purpose of changing replaceable batteries, may cause damage that is not covered under the warranty. Wireless Alert PRO products do not contain any replaceable batteries or user serviceable parts. Servicing should only be provided by an authorised supplier.



Disposal and Recycling Information

You must dispose of Corintech Ltd products in accordance with relevant laws and regulations. They contain electronic components and therefore must be disposed of separately from household waste.



Installation

Mount bracket/product a maximum of 2m above floor level.



Issue 2 11-03-2022